

7530 Spruce Branch  
7530 Spruce Branch

#3

2007-116

Date 6-25-07

Permit #

Location JACKSON Township

NE 1/4 of Sec. 29; T 2 S; R 4 E

NEW \$50     EXISTING \$20    Date Paid 6.27.07  
 Mobile     Modular     Stick-built  
 Upgrade     Leaking     Undersized  
 Other repair    Previous permit # \_\_\_\_\_

**Harrison County Health Department**  
 245 Atwood Street / North Wing  
 Corydon, Indiana 47112  
 Phone (812) 738-3237  
 Fax (812) 738-4292  
 www.harrisoncountyhealth.com

Subdivision \_\_\_\_\_ Lot # \_\_\_\_\_

3 # BRs \_\_\_\_\_ Basement? \_\_\_\_\_ w/plumbing? \_\_\_\_\_

2 BEDROOM HOME + 1 BED OUT BUILDING

Directions to property: N.E. INT. OF SPRING BRANCH RD. & Hwy 135

Owner WAYNE SNYDER

Installer SELF

Phone \_\_\_\_\_

Phone \_\_\_\_\_

Soil evaluation by: D.R.S. Soil Loading Rate: .3 gal/day/ft<sup>2</sup>

Inches to bedrock: \_\_\_\_\_ Water Table: \_\_\_\_\_  Residential  Commercial  Other

Conventional system  Flood dose system  Mound system  Engineered system

Engineer name: CHAMBERS Dwg #: \_\_\_\_\_

1 # 1000 gal tank(s) 1 # distribution boxes #8, Curtain drain depth (inches) \_\_\_\_\_

Trench length (feet) 375 Trench width (inches) 36 Trench depth (inches) 25"

Recommendations: PUMP OUT & FILL IN OLD TANK, SET NEW TANK 10' OFF HOMES, REPLUMP ALL WASTE WATER INTO TANK STAGE (5) 75 LINES (CHAMBERS) COUNTY KEEP 25' OR MORE OFF CREEK OR MAY INSTALL (5) 75 LINES @ 48" WIDE

ALL CONSTRUCTION MUST COMPLY WITH SEPTIC RULE ISDH 410 IAC 6-8.1 and any local ordinances. Gravel in lateral lines may be 5L river gravel ONLY. Shoot grades, follow contours.

Application approved?  Yes  NO Issued by: D.R. Schroeder Environmental Health Specialist

Installation approved?  Yes  NO Date: 7-10-07 D.R. Schroeder Environmental Health Specialist

This permit in no way guarantees the operation of this private sewage disposal system. This septic permit is VOID after one (1) year. Permit is NON-TRANSFERABLE. Any changes to system design or location will VOID this permit.

7530 HWY. 135 NEW SALINA, IN

SANDY BRANCH

HOME

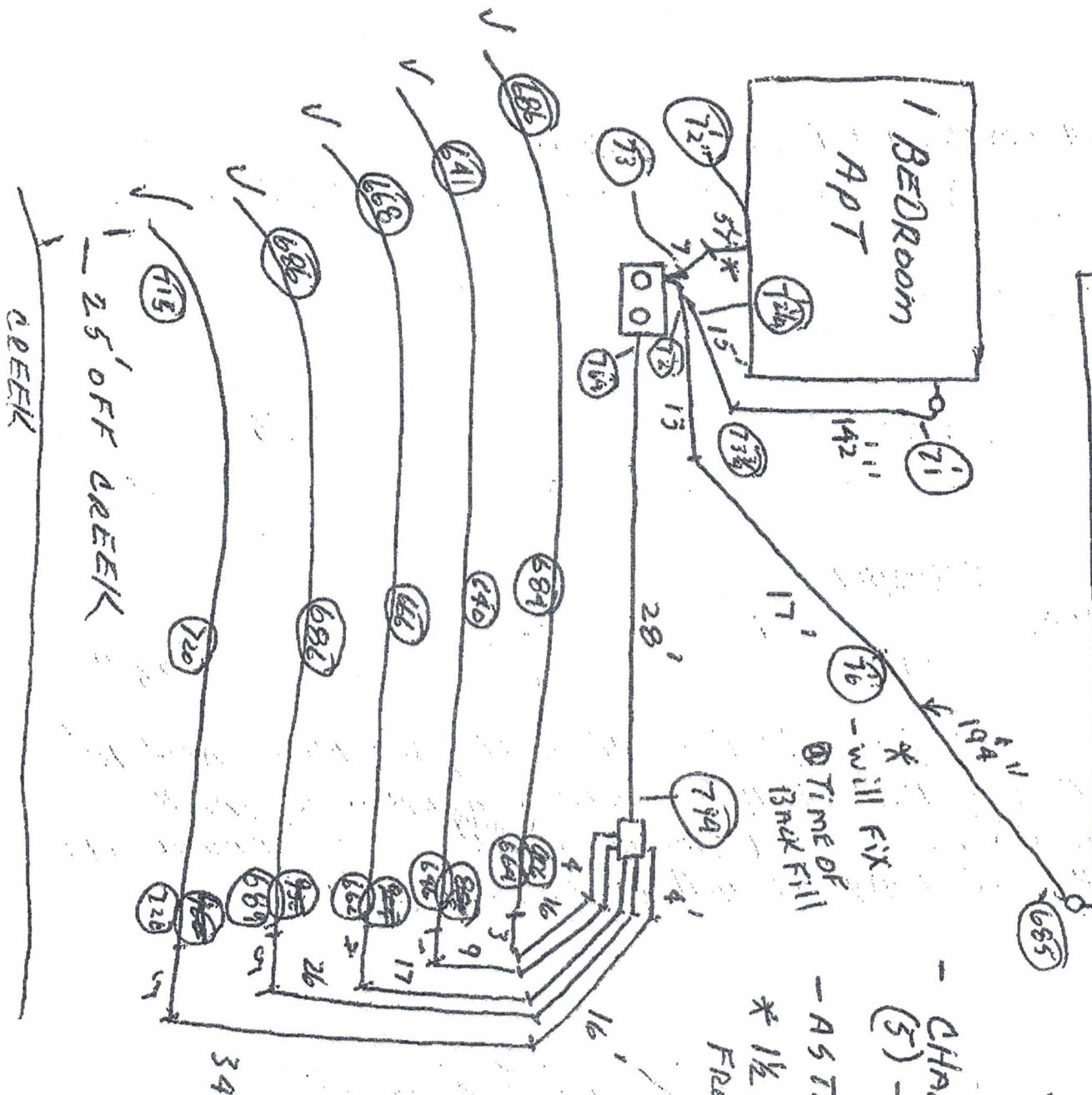

2-1